



# rapid start

This is to get you up and going quickly. For more thorough explanations and descriptions, refer to the Technical Manual.

## Assembly

Tighten the long bolt. Put the cable through one of the tabs. Thread the short bolt but stop flush. If you tighten, the rubber expands. That comes later.

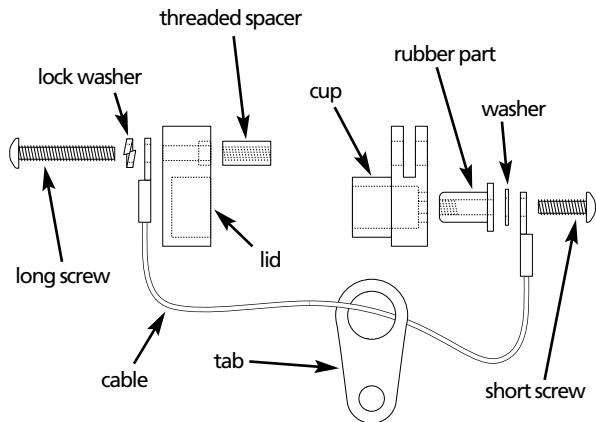

# Loading A Charge

- #1 Form a "spoon" of masking tape around the head of an electric match type igniter. Place about a BB sized pile of ffff black powder or Pyrodex on the igniter head. Fold the tape up and over the head to form a small packet on the end.

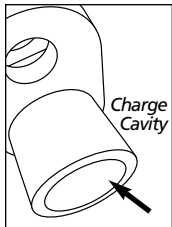
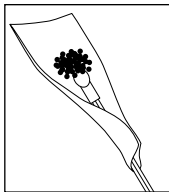

- #2 Insert the charge, igniter leads first, into the charge cavity and out the hole in the cup back.

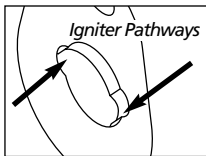

- #3 Pull through so the charge is in the cavity and position the igniter leads in the igniter pathways.

#4

Insert the rubber seal and tighten the short screw until snug. Do not overtighten. The seal expands inside the cavity. This seals the pathways.

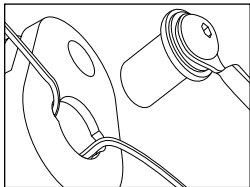

- #5 Position two tabs (one is on the cable and one is loose) over each other and line up the small holes and put the small hole ends into the slot and line the holes in the cup with the holes on the tabs. The steel rod sticking out of the lid should go through these holes when the lid is put on the cup, holding the tabs in place. Tape the sides.

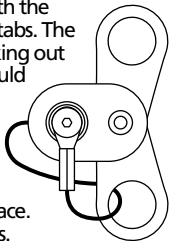

# Reefed Main Recovery Arrangement

## Summary

The apogee event separates the rocket and deploys the main chute, reefed by Tether. The rocket tumble recovers to main chute altitude. The charge is fired and Tether releases the reef, allowing the main to fill.

## Requirements

A drogue chute could be used, it is not needed.  
The electronics bay needs to be forward of the chute bay.

## Procedure

- #1 Fold a nomex chute protector in half like a taco.

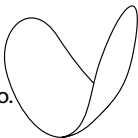

- #2 Z-fold the chute, lines first, into the "taco," back and forth until the entire chute is folded.



- #3 Roll both sides of the nomex over the chute — now it's a burrito.

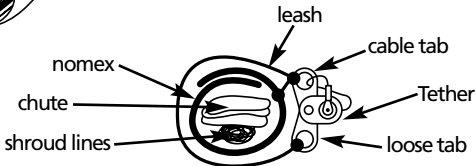
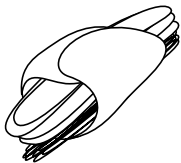

Make a short leash out of nylon or kevlar long enough to reach around the "burrito" with slack. Tie one end to the loose tab. Wrap around and tie to the other tab (with the cable going through it) leaving a little extra tail. Tie the tail to the nomex so you don't lose it.

